



AIA Document G701™ - 2001

Change Order

PROJECT (Name and address):
Johnson County Adult Probation
Building
425 W. Chambers Street
Cleburne, Texas 76033

CHANGE ORDER NUMBER: 002
DATE: April 29, 2013

OWNER:
ARCHITECT:
CONTRACTOR:
FIELD:
OTHER:

TO CONTRACTOR (Name and address):
Pete Durant and Associates
2040 Golden Triangle Drive
Fort Worth, Texas 76117

ARCHITECT'S PROJECT NUMBER: 1537-09
CONTRACT DATE: October 24, 2011
CONTRACT FOR: Construction Manager as Constructor

THE CONTRACT IS CHANGED AS FOLLOWS:

(Include, where applicable, any undisputed amount attributable to previously executed Construction Change Directives)

- Cost Issue 51: Used mobile shelving and installation. \$26,184.96
- Cost Issue 58: Overhead Profit and insurance not shown in CO#1. \$8,359.30
- Cost Issue 66: Stone installation for retaining wall along Buffalo and Chambers. \$11,059.98

The original Contract Sum was	\$ 4,511,940.00
The net change by previously authorized Change Orders	\$ 108,116.27
The Contract Sum prior to this Change Order was	\$ 4,620,056.27
The Contract Sum will be increased by this Change Order in the amount of	\$ 43,604.24
The new Contract Sum including this Change Order will be	\$ 4,663,660.51

The Contract Time will be unchanged by Zero (0) days.
The date of Substantial Completion as of the date of this Change Order therefore is April 28, 2013

NOTE: This Change Order does not include changes in the Contract Sum, Contract Time or Guaranteed Maximum Price which have been authorized by Construction Change Directive until the cost and time have been agreed upon by both the Owner and Contractor, in which case a Change Order is executed to supersede the Construction Change Directive.

NOT VALID UNTIL SIGNED BY THE ARCHITECT, CONTRACTOR AND OWNER.

Magee Architects, L.P.
ARCHITECT (Firm name)

2824 W. 7th Street, Ste. 100
Fort Worth, Texas 76107
ADDRESS

BY (Signature)

Alan Magee
(Typed name)

5-24-13
DATE

Pete Durant and Associates, Inc.
CONTRACTOR (Firm name)

2040 Golden Triangle Drive
Fort Worth, Texas 76177
ADDRESS

BY (Signature)

Darrell Durant
(Typed name)

5-24-13
DATE

Johnson County Texas
OWNER (Firm name)

2 North Main Street
Cleburne, Texas 76033
ADDRESS

BY (Signature)

County Judge Roger Harmon
(Typed name)

6-10-13
DATE



2040 Golden Triangle Drive
 Fort Worth, TX 76177
 Ph : (817)439-3213

COST ISSUE / PROPOSAL QUOTATION

To: Robert Tate
 Magee Architects, LLP
 2824 West 7th Street
 Fort Worth, TX 76107
 Ph: 817-731-9392 Fax: 817-731-9397

Number: 51
 Date: 2/13/13
 Job: 2-1-02 Adult Probation - Johnson Crty
 Phone:

Description: Filing System
 Reason: Owner Request
 Initiated by: Robert Tate (Magee Architects, LLP)
 Source: Other

We are pleased to offer the detail pricing below to make the following changes:
 Furnish and install pre-owned Kardel legal size mechanical assist shelving system per ISC quote.

APPROVED 2-26-2013

Subs/Vendors	Description	Price
ISC Labels & Equipment	Shelving system	\$23,250.00
Pete Durant and Associates	Shelving system	\$406.96
		Subtotal: \$23,736.96
	Insurance	\$23,736.96 2.00% \$474.74
	Bond	\$24,211.70 3.00% \$726.35
	Overhead/Profit	\$24,938.05 5.00% \$1,246.91
		Total: \$30,184.96

If you have any questions, please contact me at 817-439-3213.

Submitted by: Tom Pardi
 Pete Durant & Associates, Inc.

Cc: Jobfile

Architect _____
 Date: _____
 Owner _____
 Date: _____

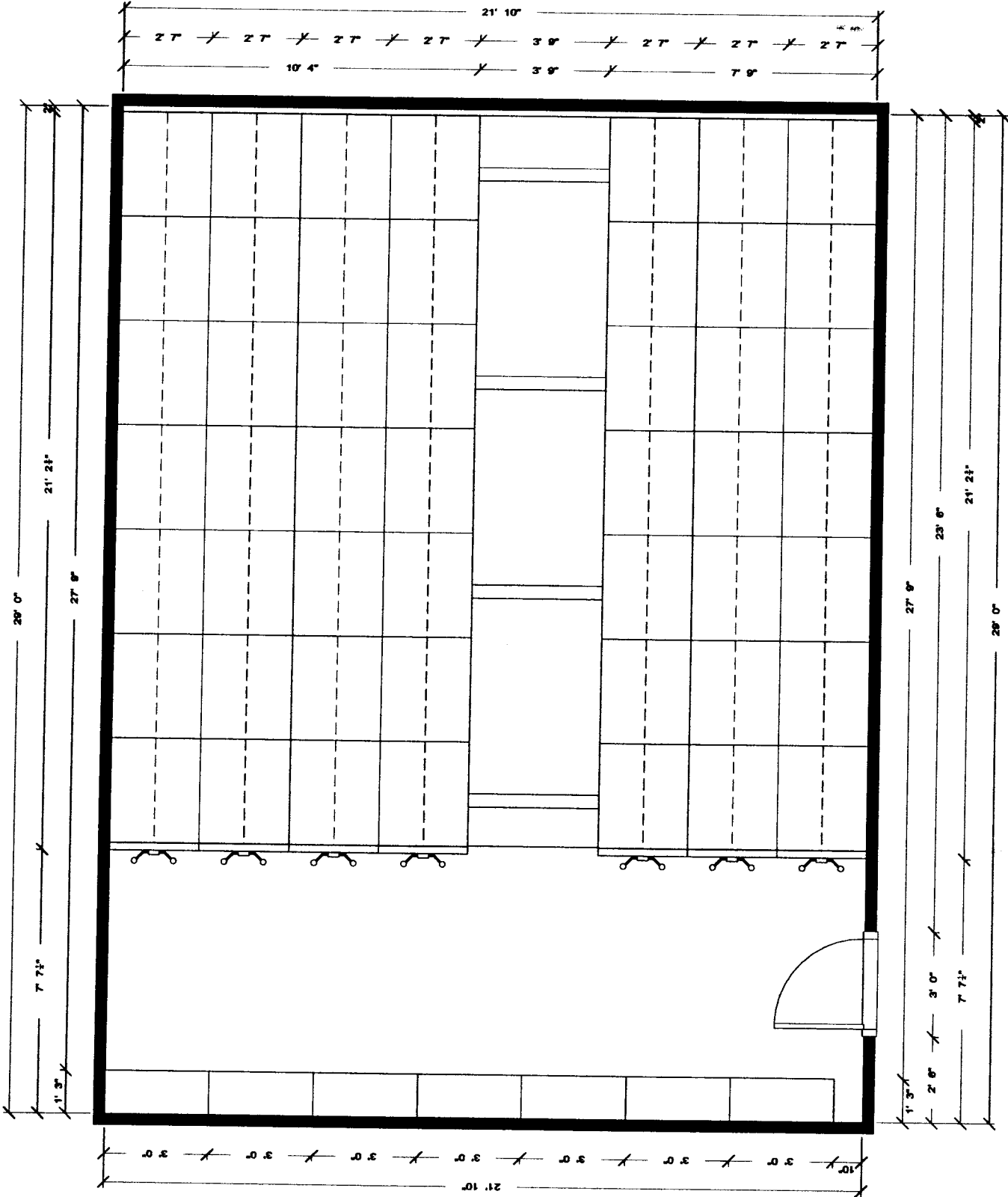

All dimensions, size designations given are subject to verification on job site and adjustment to fit job conditions.

Metroplex Shelving Solutions

This is an original design and must not be released or copied unless applicable fee has been paid or job order placed.

ISC 21ft... .ofc
Fp I
Drawing #: 1
No Scale.

Designed: 4/23/2003
Printed: 2/7/2013



P.O. Box 170066
 Arlington, Texas
 76003-0066
 Metro (817) 654-1985
 Fax (817) 654-0370

PRICE QUOTE

TO: MAGEE ARCHITECTS L.P.
 2824 WEST 7TH STREET, SUITE 100
 FORT WORTH, TEXAS 76107

DATE: 2/11/2013

PAGE 2 OF 2

project: JOHNSON COUNTY ADULT PROBATION
 ATTN: ROBERT TATE

PREOWNED KARDEX LEGAL SIZE MECHANICAL ASSITS SHELVING SYSTEM

ITEM	Q.	CATALOG #	DESCRIPTION	UNIT	PER	PRICE
			C. PRICE INCLUDES STEEL END PANELS WITH CHAIN BOX COVERS. D. PRICE INCLUDES FREIGHT, INSTALLATION AND ALL NECESSARY HARDWARE. E. PRICE INCLUDES FIVE YEAR WARRANTY EQUIPMENT AND LABOR. F. TOTAL LINEAR FILING INCHES 20,160 G. DELIVERY APPROXIMATELY 2 - 4 WEEKS.			

Terms: NET 30 DAYS
 F.O.B. CLBURNE, TEXAS

Transportation or Delivery via: I.S.C

This purchase order is made for immediate acceptance and is subject to change without notice. If based on specially printed forms, it presupposes your acceptance of overruns or underruns not exceeding 10% of quantity ordered. Deliveries are subject to delays from fire, strikes or other causes beyond our control. We reserve the right to correct clerical errors.

Accepted by: _____

Very truly yours,

By _____
 MIKE FOLLOWILL



P.O. Box 170066
 Arlington, Texas
 76003-0066
 Metro (817) 654-1985
 Fax (817) 654-0370

PRICE QUOTE

TO: MAGEE ARCHITECTS L.P.
 2824 WEST 7TH STREET, SUITE 100
 FORT WORTH, TEXAS 76107

DATE: 2/11/2013

PAGE 1 OF 2

project JOHNSON COUNTY ADULT PROBATION
 ATTN: ROBERT TATE

PREOWNED KARDEX LEGAL SIZE MECHANICAL ASSIST SHELVING SYSTEM

ITEM	Q.	CATALOG #	DESCRIPTION	UNIT	PER	PRICE
1	LOT	SPECIAL	<p>SYSTEM TO PROVIDE:</p> <p>A. ONE STATIONARY RANGE 15 INCHES IN DEPTH 21 FEET IN LENGTH. RANGE TO PROVIDE SEVEN SINGLE FACE SECTIONS OF L & T TYPE SHELVING. EACH UNIT TO HAVE SEVEN SHELVES WITH SIX OPENINGS. EACH OPENING TO PROVIDE THREE ADJUSTABLE DIVIDERS.</p> <p style="text-align: center;">UNIT DIMENSIONS: HEIGHT 76" INCHES WIDTH 36" INCHES DEPTH 15" INCHES</p> <p>B. SEVEN MECHANICAL ASSIST RANGES 30 INCHES IN DEPTH AND 21 FEET IN LENGTH. RANGES TO PROVIDE SEVEN DOUBLE FACE SECTIONS L & T TYPE SHELVING. EACH UNIT TO HAVE SEVEN SHELVES WITH SIX OPENINGS. EACH OPENING TO HAVE ONE CENTER STOP. FOR A TOTAL OF TWELVE OPENINGS PER SECTION. EACH OPENING TO PROVIDE THREE ADJUSTABLE DIVIDERS.</p> <p style="text-align: center;">UNIT DIMENSIONS: HEIGHT 76" INCHES WIDTH 36" INCHES DEPTH 30" INCHES</p>		LOT	\$23,250.00

Terms: NET 30 DAYS

F.O.B. CLEBURNE, TEXAS

Transportation or Delivery via: I.S.C

This purchase order is made for immediate acceptance and is subject to change without notice. If based on specially printed forms, it presupposes your acceptance of overruns or underruns not exceeding 10% of quantity ordered. Deliveries are subject to delays from fire, strikes or other causes beyond our control. We reserve the right to correct clerical errors.

Accepted by: _____

Very truly yours,

By _____
MIKE FOLLOWILL



2040 Golden Triangle Drive
Fort Worth, TX 76177
Ph : (817)439-3213

COST ISSUE / PROPOSAL QUOTATION

To: Alan Magee
Magee Architects, LLP
2824 West 7th Street
Fort Worth, TX 76107
Ph: 817-731-9392 Fax: 817-731-9397

Number: 58
Date: 2/28/13
Job: 2-1-02 Adult Probation - Johnson Cnty
Phone:

Description: Correct Overhead & Profit - removed from CO #1 items

We are pleased to offer the detail pricing below to make the following changes:

Corrections to Change Order #1

Moved Contingency Items to Change Order #1 - no Overhead or Profit was included. See attached.

Subs/Vendors	Description	Price
	Add OH to CO Items	\$8,359.30
		Subtotal: <u>\$8,359.30</u>
		Total: <u>\$8,359.30</u>

If you have any questions, please contact me at 817-439-3213.

Submitted by: Tom Pardi
Pete Durant & Associates, Inc.

Architect _____
Date: _____
Owner _____
Date: _____

Cc:

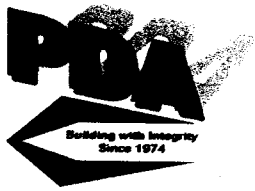

2040 Golden Triangle Drive
 Fort Worth, TX 76177
 Ph : (817)439-3213

COST ISSUE / PROPOSAL QUOTATION

To: Robert Tate
 Magee Architects, LLP
 2824 West 7th Street
 Fort Worth, TX 76107
 Ph: 817-731-9392 Fax: 817-731-9397

Number: 66 Rev-2
 Date: 3/29/13
 Job: 2-1-02 Adult Probation - Johnson Crty
 Phone:

Description: Stone Masonry Work at Buffalo St.

Reason: Owner Request

Initiated by: Robert Tate (Magee Architects, LLP)

Source: ASI # SA11A

We are pleased to offer the detail pricing below to make the following changes:

Stone Masonry Work at Buffalo St.
 Install Owner furnished Stone on new existing Concrete retaining wall.

Subs/Vendors	Description	Price
Trey S Construction, Inc.	Stone work Buffalo St. Retaini	\$8,300.00
Pete Durant & Associates, Inc.	Stone work Buffalo St. Retaini	\$1,726.00
		Subtotal: \$10,026.00
	Ins	\$10,026.00 2.00% \$200.52
	Bond	\$10,226.52 3.00% \$306.80
	Overhead/Profit	\$10,533.32 5.00% \$526.66
		Total: \$11,866.98

If you have any questions, please contact me at 817-439-3213.

Submitted by: Tom Pardi
 Pete Durant & Associates, Inc.

Cc: Jobfile

Architect _____
 Date: _____
 Owner _____
 Date: _____

Trey S Construction
P.O. Box 40562
Fort Worth, TX. 76140

Proposal Quote for Proposal Request #66, Install owner furnished Stone at the corner of Buffalo St.
Per drawings SA11A and SA11B.

For the sum of: \$8,300.00

3-29-13

Lynn Steelman
Trey S Construction